

# STEP press-in grating LYX3311S (serrated support bar).idw

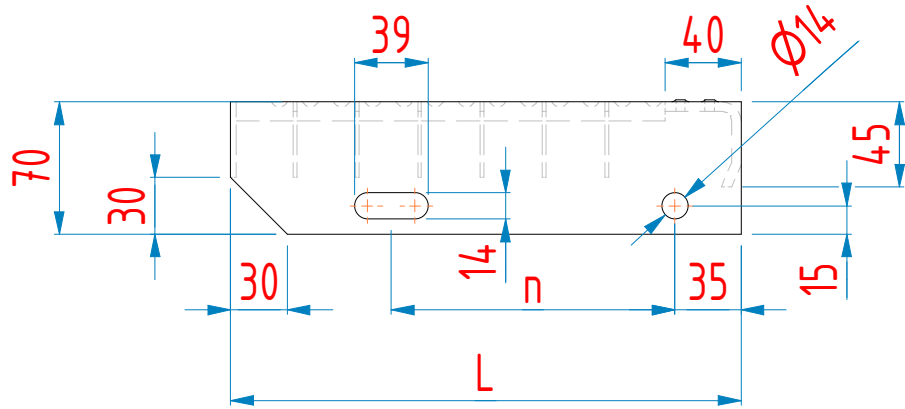

DET.1

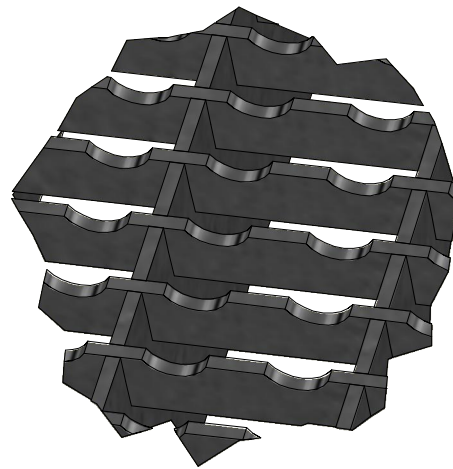

L [mm]	n [mm]
160	80
200	80
240	120
270	150
305	180

Step with kick plate



Comments  
 1. All indeterminate welds: T-welds as fillet welds a = 3  
 2. Connection of elements do as butt welds with full penetration  
 3. With hot-dip galvanized components, welds should be closed.

PN-EN 1090 EXC2; CE	General tolerances regarding the construction welded according to NS/SS-EN ISO 13920 class B						Material Steel S235JR NS/SS-EN 10025-2
	Above 30 to 120	Above 120 to 400	Above 400 to 1000	Above 1000 to 2000	Above 2000 to 4000	Above 4000	
	±1	±2	±3	±4	±6	±8	

Antal Quantity	Vi ansvarar ej för trappans stabilitet vid infästningspunkter mot omkringliggande konstruktion.					
Titel Title	Ytbehandling surface treatment		Gen. tolerans General tolerances		Skala Scale	A4
Massa Mass	Ref.dwg's		EN ISO13920:1996 cl.B		1:20	
Konstr. Godk.	22.12.21-TM					
Ritn.nr DwgNo			STEP press-in grating LYX3311S (serrated support bar).idw			Rev



Moster Skuggas Väg 7  
64171 ARVIKA SWEDEN  
Tel 0571-181077  
www.abcsolutions.se